



# UFE1160

## 1HR FIRE RATED SPEAKER COVER

### PRE-CONSTRUCTION INSTALL GUIDE



UFE1160

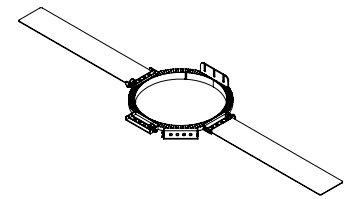

USE REBR68 PRE-CONSTRUCTION BRACKET

#### DESCRIPTION

The UFE1160 is an UL fire-rated flexible sound dampening system that take the place of a traditional in-ceiling back box. Can be used during pre-construction for any ceiling cutout size up to 10<sup>5/8"</sup>. You can use the UFE1160 with or without the new construction brackets.

#### SAFETY GUIDELINES

Be sure the electricity to the system you are working on is turned off; either the fuse removed or the circuit breaker set at off.

#### CONTAINS STONE WOOL INSULATION

Stone fibers may cause temporary mechanical irritation to the skin, throat, nose and eyes.

#### FIRST AID

**SKIN** | If irritation occurs, do not rub or scratch. Rinse under running water prior to washing with mild soap and water. Consult a physician if irritation persists.

**THROAT AND EYES** | If irritation occurs, flush eyes with water and/or drink water to clear throat. Do not rub the eyes. Consult a physician if irritation persists.

#### PRECAUTIONS

Wear long sleeve, loose fitting clothing, gloves and eye protection. For additional information, refer to the Material Safety Data Sheet.



# UFE1160

## 1HR FIRE RATED SPEAKER COVER

### PRE-CONSTRUCTION INSTALL GUIDE

**STEP 1.** Use a blade to pierce a small hole where the two grooves are located at the top of the UFE1160 speaker Cover. Draw the wire cables through the opening.

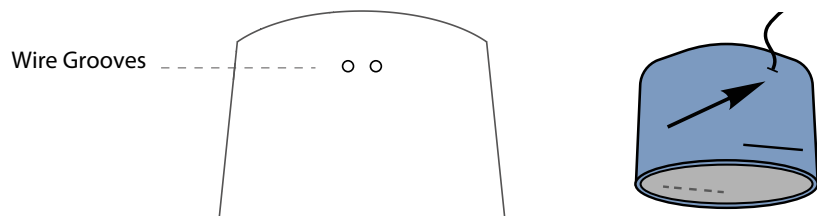

**STEP 2.** Use a blade to slice a small slit along the sides of the UFE1160 Speaker Cover, each  $3\frac{1}{2}$ " long, located at  $\frac{1}{2}$ " from the bottom.

Cut slits for REBR68 Pre-Construction Bracket:

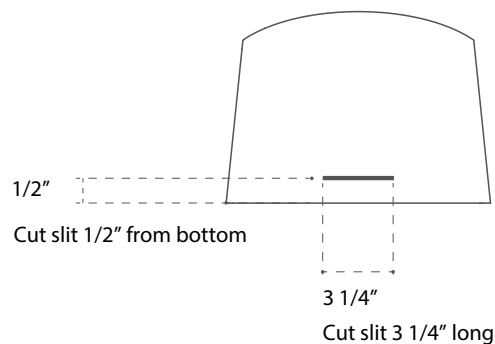

**STEP 3.** Place the 2 wings of the REBR68 Pre-Construction Bracket through the  $3\frac{1}{2}$ " slits at the bottom of the UFE1160 Speaker Cover.

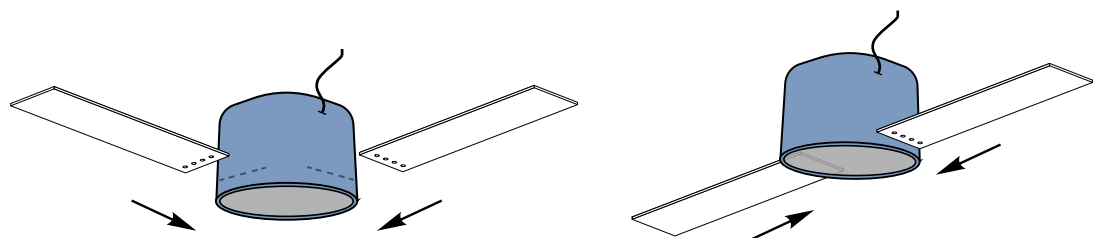



# UFE1160

## 1HR FIRE RATED SPEAKER COVER

### PRE-CONSTRUCTION INSTALL GUIDE

**STEP 4.** Carefully insert the REBR68 bracket into the UFE1160 Speaker Cover and then connect the 2 REBR68 wings to the bracket. Install the REBR68 bracket to the joists as usual, referring to the REBR68 Manual for additional guidelines.

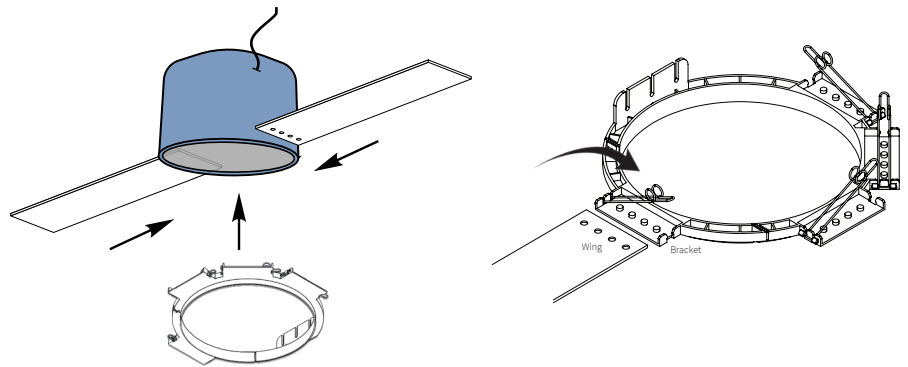

**STEP 5.** Make sure that the speaker cover sits flush with the REBR68 bracket. Install the REBR68 bracket to the joists as usual. Install drywall. Refer to the REBR68 Manual for guidelines.

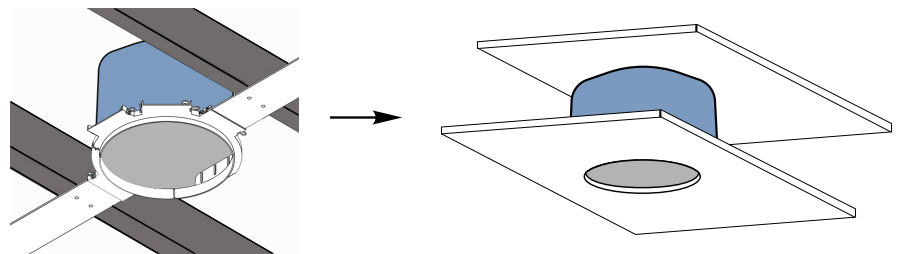

**STEP 6.** Once drywall is ready, install the BZ ring and the speaker as usual. Refer to the Director Collection Speaker Manual for guidelines.

